

Intelligent LED luminaire

HERMES LOG NX+

5 YEARS
WARRANTY



ELECTRICAL CHARACTERISTICS

Driver	Osram
Power supply	198-270V~ 50/60Hz
Power factor (cosφ)	≥0.95
Control options	1-10V, DALI
Protection class	I

LUMINOUS CHARACTERISTICS

Light source	Lumileds LEDs
Luminaire efficacy	170lm/W
Beam angle	120D
Colour temperature	4000K
CRI	>80

GENERAL CHARACTERISTICS

Type of housing	Aluminium
Type of diffuser	PC frosted
Tool-free electrical connection	Yes
Protection degree IP	IP65
Impact resistance degree IK	IK09
Operating temperature	-25°C ÷ +55°C
Lifetime (L90B10)	>80 000h
Installation	Suspended, surface-mounted
Mounting height	2-6m
Application	Production halls, warehouses, sports facilities, commercial facilities
Certificates	CE, RoHS

Power	Luminous flux (measured on the luminaire)	Rated current	Inrush current	Inrush time ⁽²⁾	Weight	Dimensions
70W	12 000lm	0.36A	30A	0.20ms	3.3kg	L1500xW83xH68mm

(2) measured up to 50% of the peak value of the starting current

PHOTOMETRY

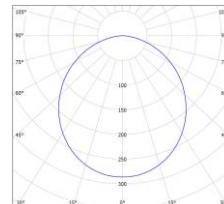

120D

TECHNICAL DRAWING

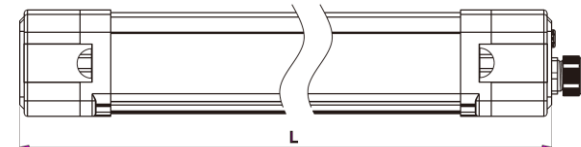
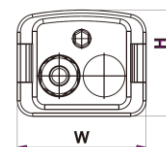

ACCESSORIES

1. Mounting cables

For hanging the luminaire l=1.45m.